

CAT ALOGUE



SENZANI

From innovation to pack

Specialists in automatic packaging technology



Since 1953 Sensani has been producing packaging machines to meet any need arising in the production process: from **primary and secondary packaging**, up to **palletisation and end-of-line solutions**. Relying on its first-level engineering tradition, Sensani offers **integrated systems and complete turnkey lines**, including the management of Greenfield projects.

This is what makes Sensani an active partner for technological development, one that can design and implement specific solutions in different fields of application, as well as meet the Customer's different needs: from packaging lines (packaging materials, type and design) up to the entire production plant (logistics management, supply chain, etc.). Thanks to our many years of experience and in-depth knowledge of the industry, Sensani provides **complete guidance** to the Customer, guaranteeing an extremely professional and competent support in the different phases in order to create high profitability solutions and systems.

Over the years Sensani has **installed over 2.200 machines worldwide** for the most important companies and multinational corporations, ranging from the food to the tobacco industry.

CUSTOMISATION

Our **cutting-edge R&D Department** creates the most efficient and customised solutions to meet the demands of the market. Regardless of the Customer's needs or marketing requirements, we can provide highly tailored packaging solutions.

INNOVATION

The focus on innovation is testified by the **more than 70 patents** deposited over the years in Europe, the USA and other countries. Our commitment to innovation is also reflected by the implementation of applications and devices that make production, maintenance and installation of machinery more efficient: **automation, collaborative robots, augmented reality and advanced remote diagnostics**.

SUSTAINABILITY

Senzani has always promoted **plastic-free packaging solutions** in the full respect of the environment, thanks to our expertise in the manufacture of cartoners and case packers processing paperboard and cardboard products. Furthermore, Sensani machines rely on the most innovative technologies to improve the energy efficiency of the production plant.

Our Story

1953

The first automatic machine for spaghetti cutting gives the sparkle to Senzani production

1960

Registration of the first patents

1966

Manufacture of the first vertical cartoner, S400, performing 400 carton/minute and still running today

1969

Senzani enters the tobacco sector with the first case packers

1992

Patent for the revolutionary high-speed NPU turret

2003

Installation of the great stele for the company's 50th anniversary

2010

The portfolio is expanded with new solutions to pack products in trays and displays

2015

Launch of TLCM, the innovative all-in-one top-load cartoner for ordered coffee capsules, later called OMNIA

2018

The range is completed with wrap-around and tray+lid solutions for secondary packaging

2019

HCM technology for horizontal cartoning from pre-glued cartons is developed

2020

Introduction of SMART, the IoT platform allowing performance monitoring, maintenance management and remote support

2021

ORIGAMI, the new generation of high-performance machinery with iTRAK technology, is launched

2023

The company celebrates 70 years in the business

Solutions



Machines for the introduction of products in American and wrap-around cases, trays and lids



Vertical cartoners and machines to set-up, fill and seal cartons, trays and displays



End-of-line machines, palletisers and special applications

Sectors



Pasta



Coffee and Tea



Sauces - Spices
Salt



Cereals and
Dried fruit



Confectionery
and sugar



Chemicals



Pet food



Ready meals



Dairy



Frozen products



Purea - Drinks
Smoothies



Agriculture



Personal care
Detergents



Tobacco



Cartoners

LEADING MANUFACTURER OF VERTICAL CARTONERS
FOR OVER 70 YEARS

Innovative packaging systems for the **set-up and final sealing of pre-glued cardboard cartons**, which are filled with the product (loose or pre-packaged) by vertical fall; automatic cartoning machines **from flat blank**, specifically designed to set-up, fill and seal trays and displays and to handle a wide range of products such as as bags, tubs, tins and cans, tubes and coffee capsules.

Wide range of customisation options

Different production speeds

Maximum flexibility in layout design and carton management (by shape, size, dosage and closing process)

Form-and-fill or wrap-around technology, depending on the product to be packaged

Management of products in both vertical and horizontal position

model	speed
VCM	max. 150 cartons per min.
VCMA	max. 60 cartons per min.
VCMX	max. 350 cartons per min.
VCMK	max. 600 cartons per min.
TLCM	max. 60 cartons per min.
WACM	max. 25 cartons per min.
HCM	max. 120 cartons per min.

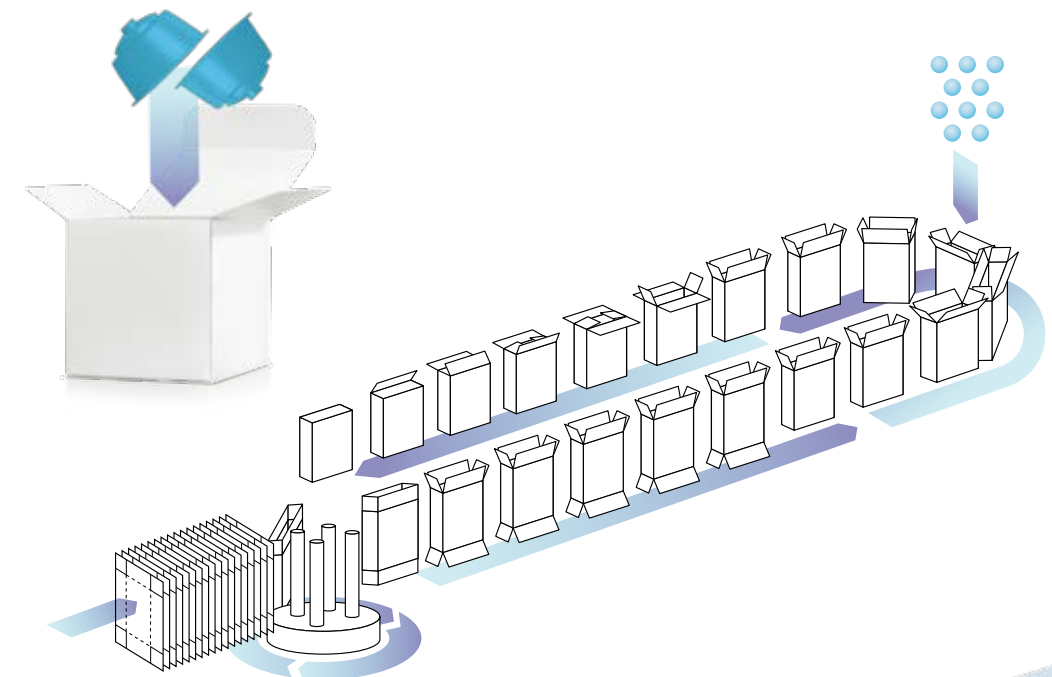

All these machines are available with



VCM

Vertical cartoner with continuous motion

Carton size

min. 60 x 30 x 140 H mm.
max. 180 x 80 x 330 H mm.



Features:

Speed up to 150 cpm in continuous motion

Tool-free technology for adjustments and format parts, without the use of any equipment

Monobloc carton holders in aluminium for optimal carton handling

Parts in contact with the product in stainless steel

Positive handling of the cartons in the picking and set-up phases

Product infeed system with volumetric dosing, scales, augers or counting equipment

Maximum width in the range of available formats

Adaptability to all forms of cartons and to all closing sequences

Food grade, washable stainless steel and anti-corrosion treated version available

Limited energy consumption

Availability of all PLC platforms (Siemens; Allen Bradley; Schneider)

No product/no carton functionality and closure from stopped condition (optional)



VCMA

Vertical cartoner with index motion

Carton size

min. 90 x 40 x 140 H mm.
max. 220 x 100 x 370 H mm.

Features:

Production speed up to 60 cpm in index motion

Available closing sequences: standard, reverse, tuck-in, flip-top.

Adaptability to all forms of cartons and to all closing sequences

Tool-free technology for adjustments, without the need for external equipment

Positive handling of the cartons in the picking and set-up phases

Lifelong lubrication on many parts to reduce maintenance

Limited energy consumption

Food grade, washable stainless steel and anti-corrosion treated version available

Availability of all PLC platforms (Siemens; Allen Bradley; Schneider)

All these machines are available with

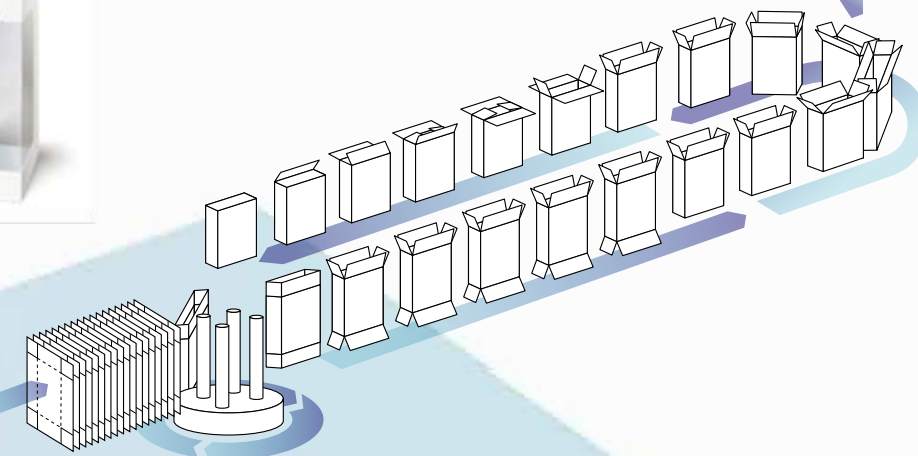

VCMX

Vertical cartoner with continuous motion at high speed

Carton size

min. 60 x 30 x 140 H mm.
max. 285 x 145 x 390 H mm.

Features:

Production speed up to 350 cpm

Continuous motion

Tool-free technology for adjustments and format parts, without the need for external equipment

Monobloc carton holders in aluminium for optimal carton handling

Parts in contact with the product in stainless steel

Positive handling of the cartons in the picking and set-up phases

Product infeed system with volumetric dosing, scales, augers or counting equipment

Maximum width in the range of available formats

Adaptability to all forms of cartons and to all closing sequences

Food grade, washable stainless steel and anti-corrosion treated version available

Limited energy consumption

Availability of all PLC platforms (Siemens; Allen Bradley; Schneider and more)

No product/no carton functionality and closure from stopped condition (optional)

All these machines are available with

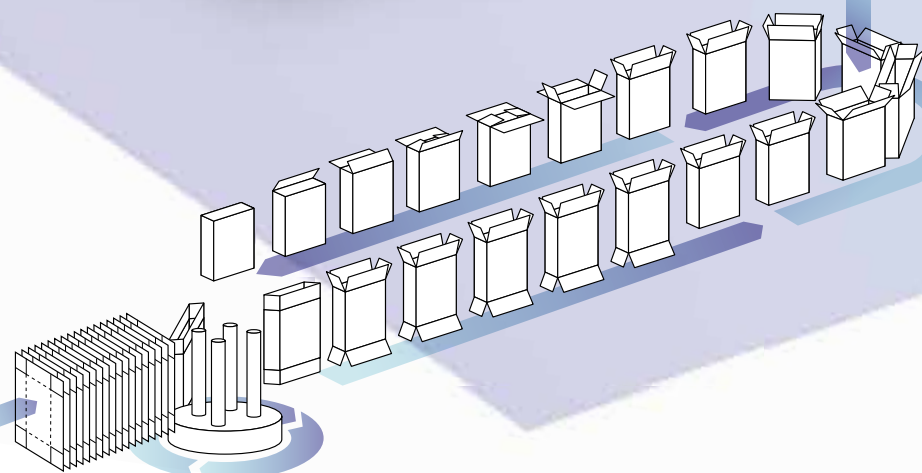
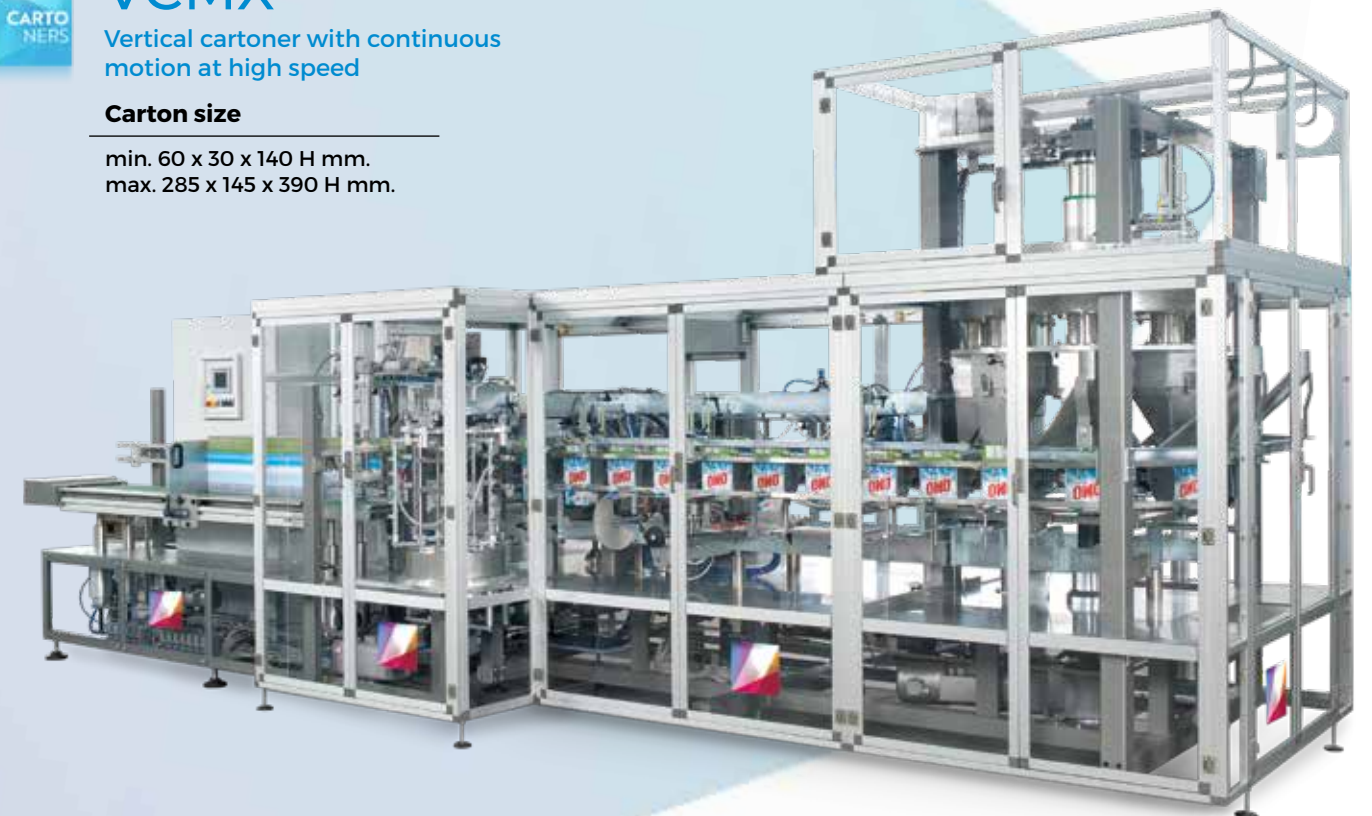



VCMK

Custom vertical
cartoner

Features:

- Max production speed 300 – 600 cpm and above
- Continuous motion
- Tool-free technology for adjustments and format parts, without the need for external equipment
- Monobloc carton holders in aluminium for optimal carton handling
- Parts in contact with the product in stainless steel
- Positive handling of the cartons in the picking and set-up phases
- Product infeed system with volumetric dosing, scales, augers or counting equipment

Maximum width in the range of available formats

Cartons magazine with possibility of integrating automatic carton loading and case de-palletising solutions.

Adaptability to all forms of cartons and to all closing sequences

Food grade, washable stainless steel and anti-corrosion treated version available

Limited power consumption, thanks to the use of a vacuum pump

Availability of all PLC platforms (Siemens; Allen Bradley; Schneider)

All these machines
are available with

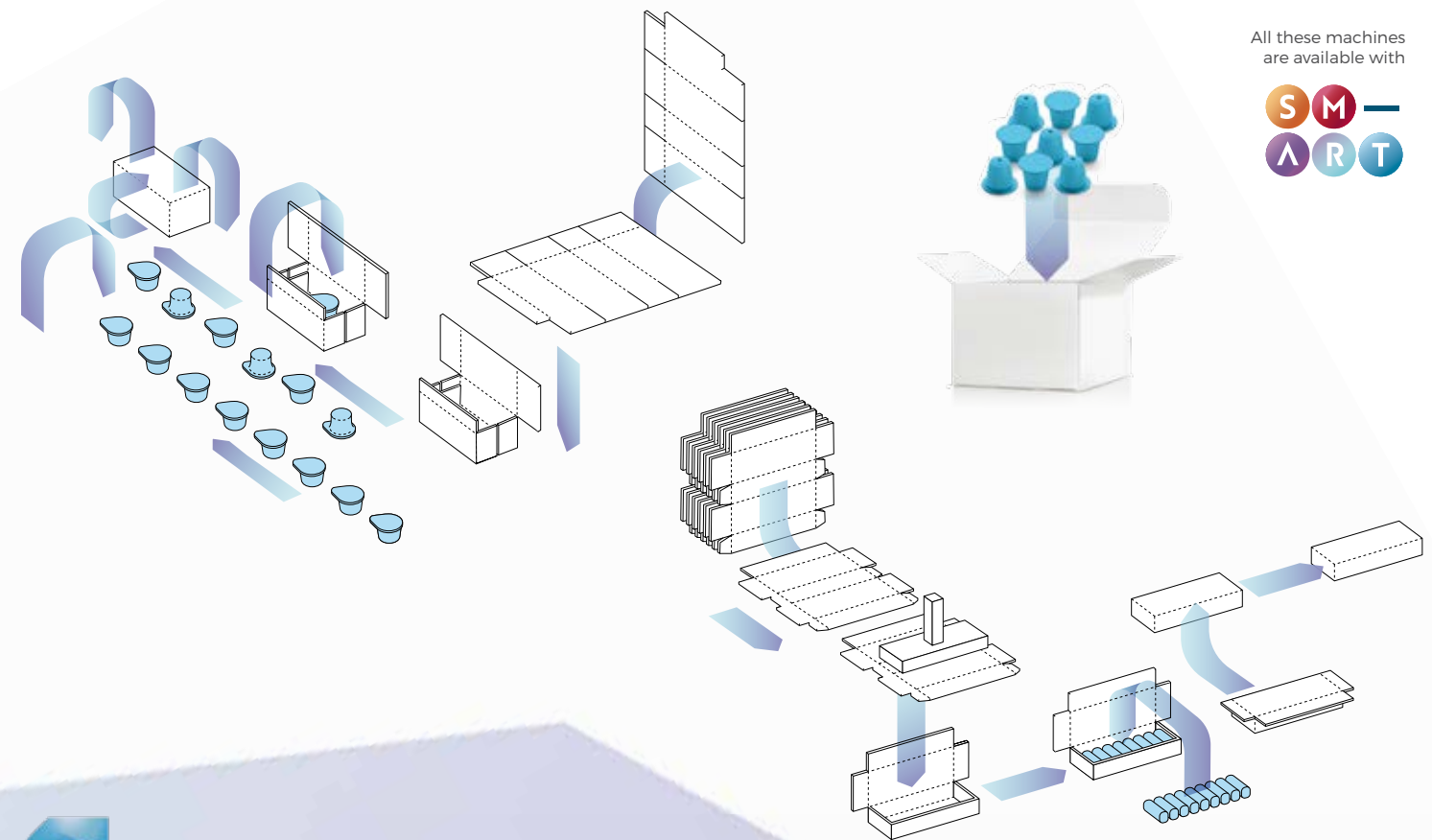

All these machines
are available with



TLCM

Top-load cartoner
from flat blank

Carton size

max. 750 x 750 H mm.



Features:

- Infeed speed up to 600/min, depending on the product type and dimensions
- Production speed up to 60 cartons/min
- Compact size and user-friendly machine, only requiring one single operator
- Pick&Place filling with delta robot, Scara, Fanuc or Cartesians
- Tool-free technology for format change and adjustments
- Version with interlayer sheet handling available

Robust design, certified components, reduced maintenance

Engineering of all elements to ensure 100% product compliance

Non-compliant products rejection with automatic control

Vision system integration

Limited energy consumption

Availability of all PLC platforms (Siemens; Allen Bradley; Schneider)

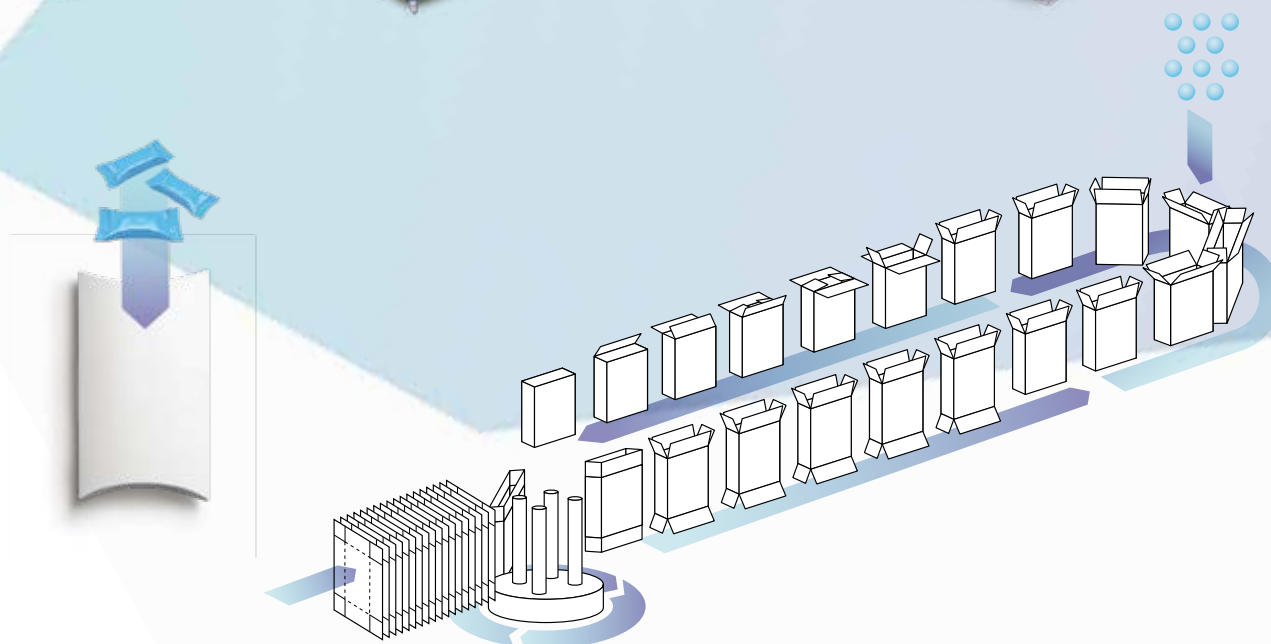



WACM

Wrap-around cartoner
from flat blank

Carton size

min. 130 x 90 x 30 H mm.
max. 250 x 100 x 100 H mm.

Features:

Suitable to wrap pre-packaged products with a regular shape as stock cubes, cartons, trays, coffee capsules, tins and cans, etc.

Infeed speed up to 1700 ppm

Production speed up to 25 cartons/min

Ergonomic vertical magazine, suitable for a wide range of formats

Tool-free technology for adjustments, without the use of external equipment, for format change adjustments

Version with interlayer sheet handling available

Robust design, certified components, reduced maintenance

Engineering of all elements to ensure 100% product compliance

Non-compliant products rejection with automatic control

Vision system integration

Availability of all PLC platforms (Siemens; Allen Bradley; Schneider)

All these machines
are available with

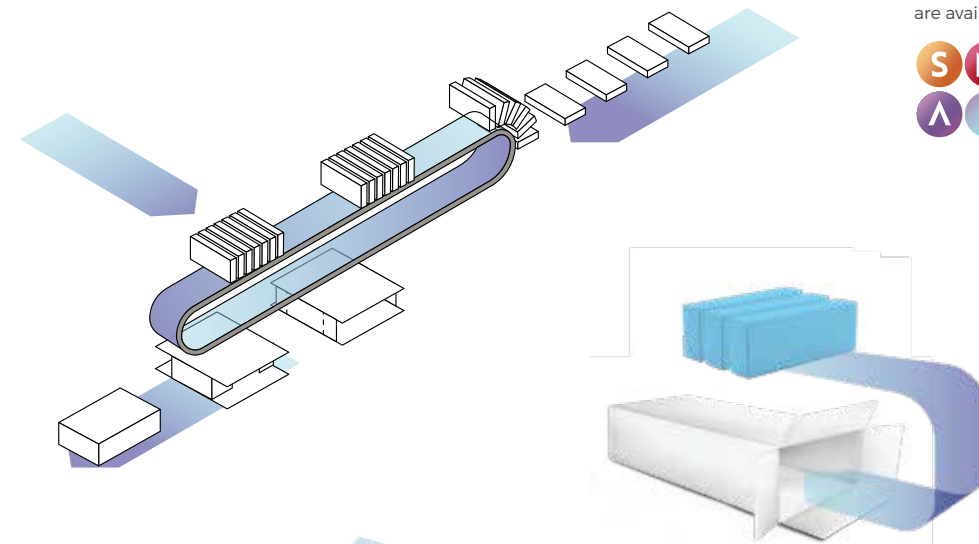

All these machines
are available with



HCM

Horizontal cartoner

Carton size

min. 60 x 30 x 140 H mm.
max. 180 x 80 x 330 H mm.

Features:

Speed up to 120 cpm in continuous motion

Tool-free technology for adjustments, without the need for external equipment

Parts in contact with the product in stainless steel

Positive handling of the cartons in the picking and set-up phases

Maximum width in the range of available formats

Cartons magazine: ergonomic, with low carton level alert and adjustable carton support surface by hand-wheel

Suitable to perform all closing sequences

Non-compliant products rejection with automatic control

Food grade, washable stainless steel and anti-corrosion treated versions available

Limited power consumption, thanks to the use of a vacuum pump

Availability of all PLC platforms (Siemens; Allen Bradley; Schneider)

Product infeed using a pocket conveyor belt

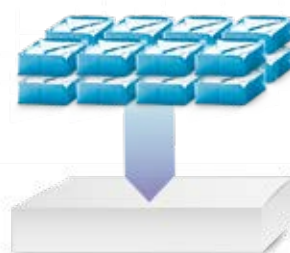
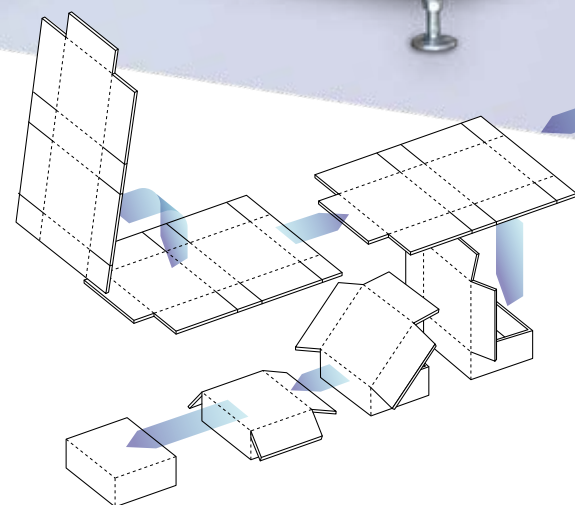



Case Packers

SECONDARY PACKAGING MACHINES

Secondary packaging solutions such as **wrap-around, tray+lid, side-load and top-load case packers**. These machines feature a modular and specular design, easily accessible and large-capacity magazines, quick and tool-free format changes, and are equipped with dedicated control systems.

Modular and specular design

Completely electronic (brushless motors)

Easily accessible case magazines offering great autonomy

Guaranteed product conformity and optimal case orthogonality

Quick format changes and tool-free technology

User-friendly and ease of use for single operator

Integration with Senzani de-palletising system

model	speed
CPWA	max. 36 cases per min.
CPTL	max. 25 cases per min.
CPSL	max. 25 cases per min.
SBNE	max. 8 cases per min.



CPWA

Wrap-around case packer

Case size

min. 100 x 250 x 110 H mm.
max. 200 x 480 x 200 H mm.

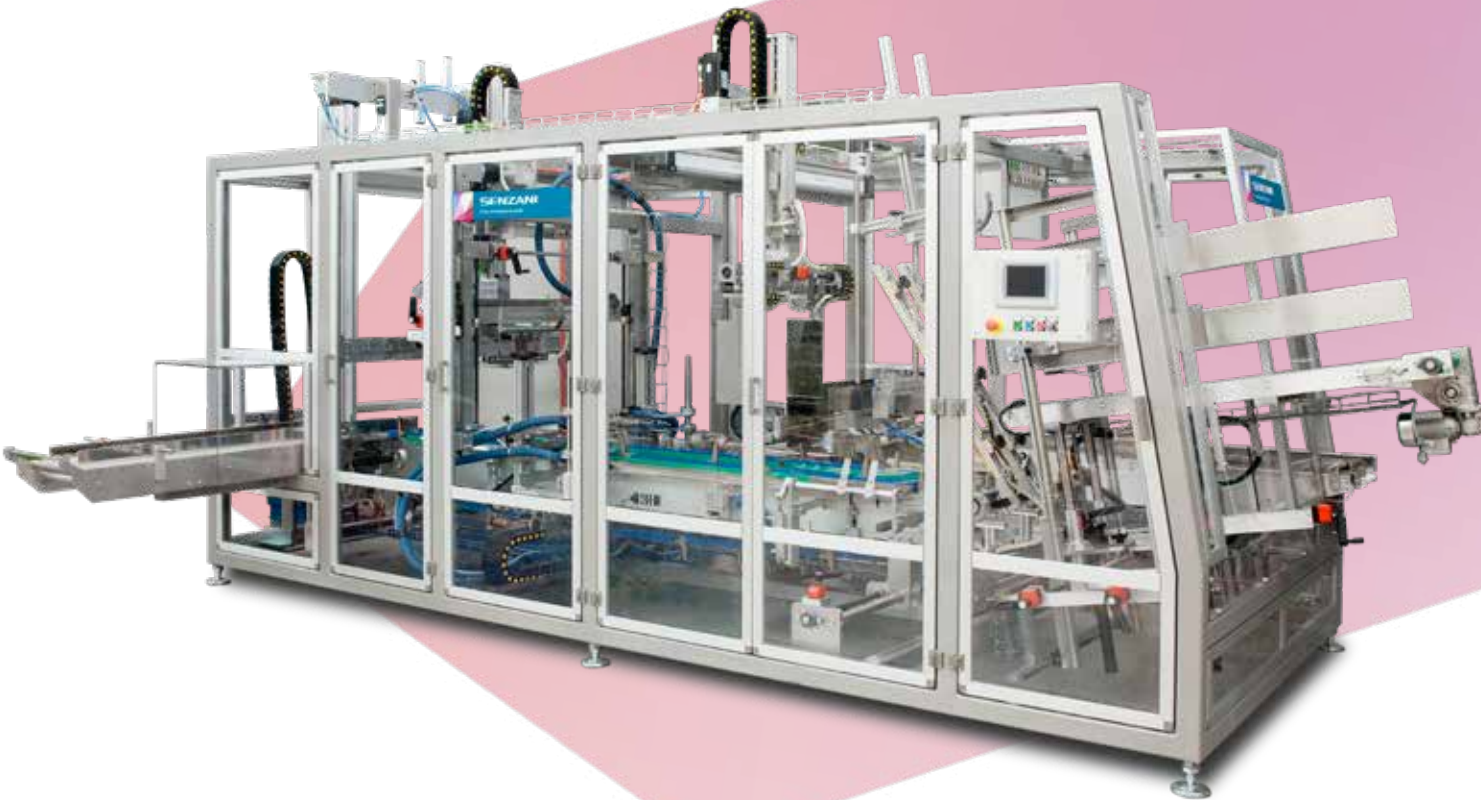
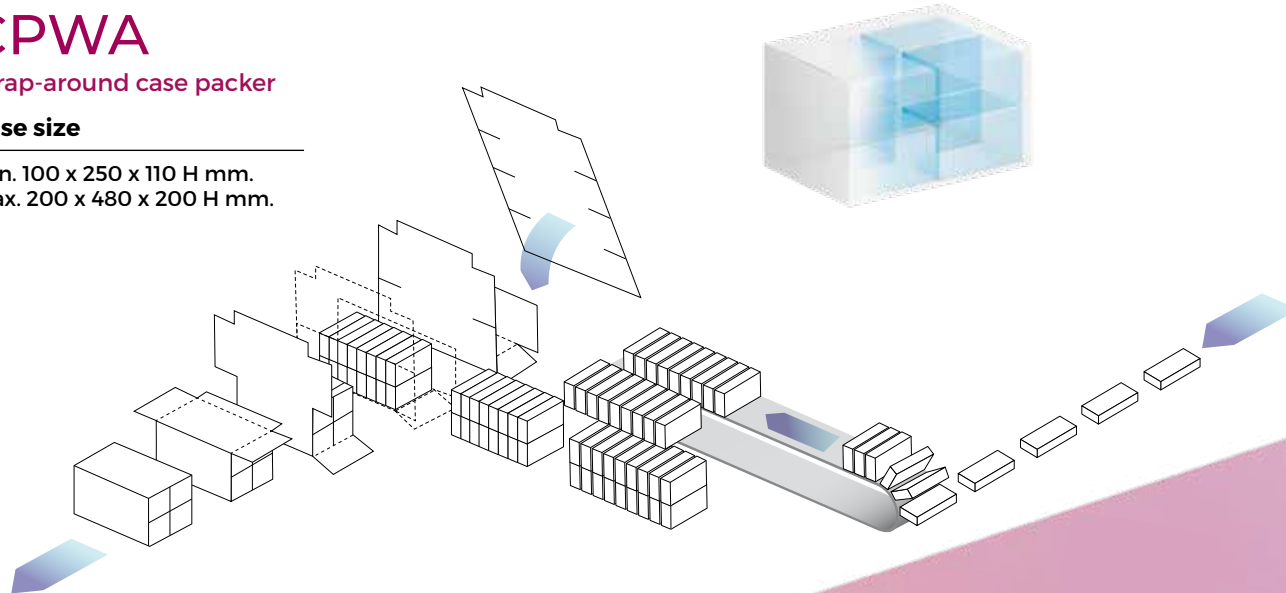

Features:

Products to be packed: cartons, tubs, bags, etc.

Production speed up to 36 cases/min

Compact size and user-friendly machine, only requiring one single operator

Closing process with hot glue

Horizontal or vertical ergonomic magazine, suitable for a wide range of formats and grammages

Completely electronic machines with brushless motors

Total flexibility according to different formats and configurations

Tool-free technology for adjustments, without the use of external equipment, for format change adjustments

Robust design, certified components, reduced maintenance

Engineering of all elements to ensure 100% product compliance

Limited energy consumption

Availability of all PLC platforms (Siemens; Allen Bradley; Schneider)



CPTL

Top-load case packer

Case size

min. 250 x 150 x 150 H mm.
max. 500 x 300 x 450 H mm.

Features:

Products to case pack: cartons, doypacks, pouches, bags, flowpacks, tins, etc.

Production speed up to 25 cases/min

Compact size and user-friendly machine, only requiring one single operator

3 in 1 monobloc machine: case opener, filling and sealing (with self-adhesive tape or hot-melt glue)

Vertical or horizontal case magazine, ergonomic, flexible to handle a wide range of formats and grammages

Completely electronic machines with brushless motors

Total flexibility according to different formats and configurations

Tool-free technology for adjustments, without the use of external equipment, for format change adjustments

Robust design, certified components, reduced maintenance

Engineering of all elements to ensure 100% product compliance

Low energy-demanding also thanks to the use of the Venturi vacuum system

Availability of all PLC platforms (Siemens; Allen Bradley; Schneider and more)

All these machines are available with

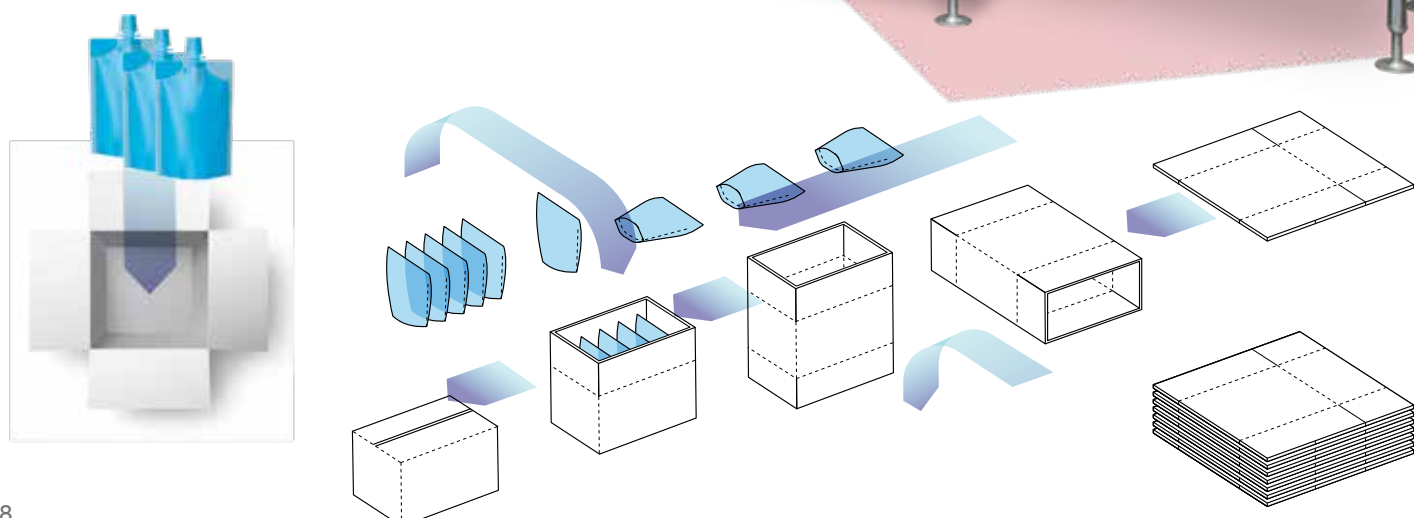
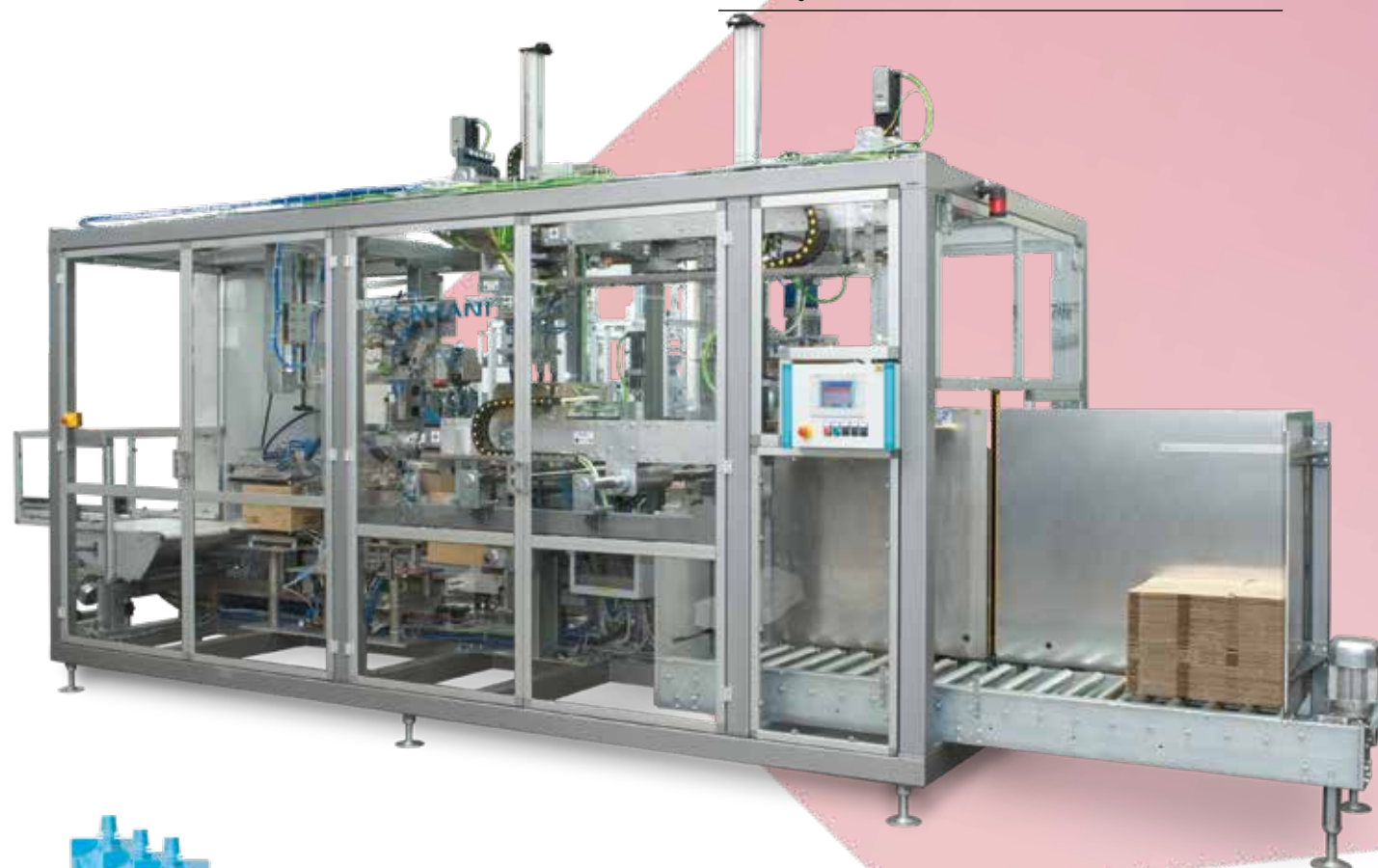

All these machines are available with

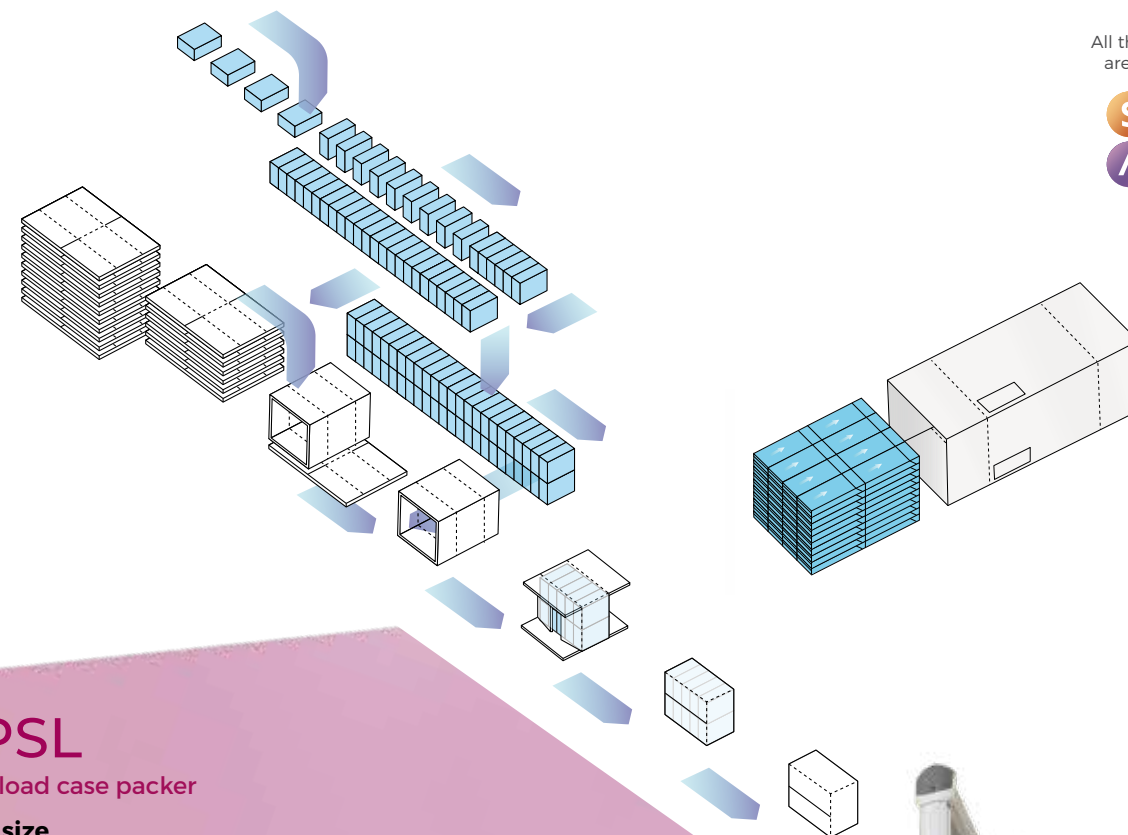

CPSL

Side-load case packer

Case size

min. 300 x 200 x 450 H mm.
max. 550 x 300 x 600 H mm.

Features:

Products to be packed: cartons, tubs, bags, etc.

Production speed up to 25 cases/min

Compact size and user-friendly machine, only requiring one single operator

Closing systems with self-adhesive tape or hot-melt glue available

Horizontal or vertical ergonomic magazine, suitable for a wide range of formats and grammages

Completely electronic machines with brushless motors

Tool-free technology for adjustments, without the use of external equipment, for format change adjustments

Robust design, certified components, reduced maintenance

Engineering of all elements to ensure 100% product compliance

Life-long bearing lubrication, centralised lubrication system available on request

Limited energy consumption

Availability of all PLC platforms (Siemens; Allen Bradley; Schneider)





SBNE

High-rise case packer

Case size

min. 350x210x220 H mm.
max. 550x390x620 H mm.

Features:

Products to be packed: regular shaped packs (e.g. cartons)

Production speed up to 8 cases/min

Compact size and user-friendly machine, only requiring one single operator

Large ergonomic magazine with vertical or double horizontal load, with positive case opening and low-level alert

Vertical elevator for overhead case outfeed

Option for case outfeed at the machine lower level

Completely electronic machines with brushless or asynchronous self-locking motors

Integration of case weight checking system

Product, cases and consumables traceability system

Wrap-around labelling system integration (Senzani system)

Robust design, certified components, reduced maintenance

Limited energy consumption

All these machines are available with



End of Line

END-OF-LINE SOLUTIONS

Over the years Senzani has developed various customised solutions and integrations for primary and secondary packaging, ensuring the complete automation of the line. The know-how acquired allows Senzani to also offer customised solutions in the fields of end-of-line machines, loading of consumables and palletising.

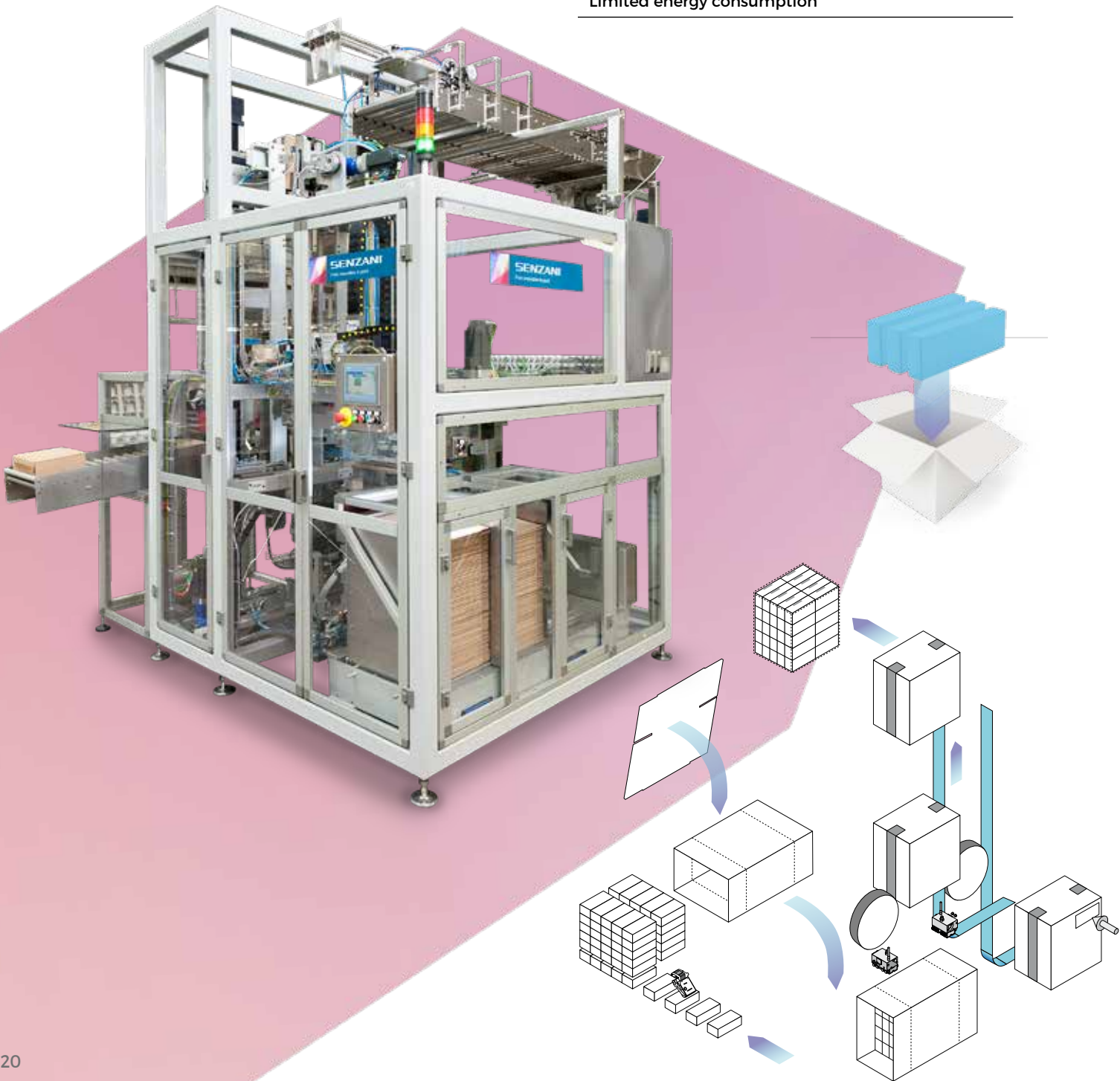

Suitable for Industry 4.0

High quality construction

Use of cutting-edge components

Extreme efficiency and line speed with particular attention to safety

Gripping head completely designed by Senzani, customisable

Tool-free adjusting technology for changing the format of the clamp, without the need for external equipment

model

speed

VCPAL

10 cartons/min.
60 layers/hour
10 pallets/hour

PAL

10 robot picks/min
up to 50 cases/min
(layer preparation in multipick)



VCPAL

Carton-palletiser

Full pallet dimensions

min. 800 x 1000 x 400 H mm.
max 1100 x 1280 x 2000 H mm.

Features:

Integrated system for case packing and palletisation

System personalisation according to the Customer's needs

Intelligent motion control technology for energy recovery

Tool-free technology for adjustments, without the need for external equipment

Maximum width in the range of available formats

Colour touch screen display

User-friendly and intuitive programming

Positive case opening and handling

Robotic arm for case packing and palletisation

Integration of Senzani automatic empty pallet magazine available

Infeed up to 30 cases/min

Output up to 5 pallets/hour

All these machines are available with

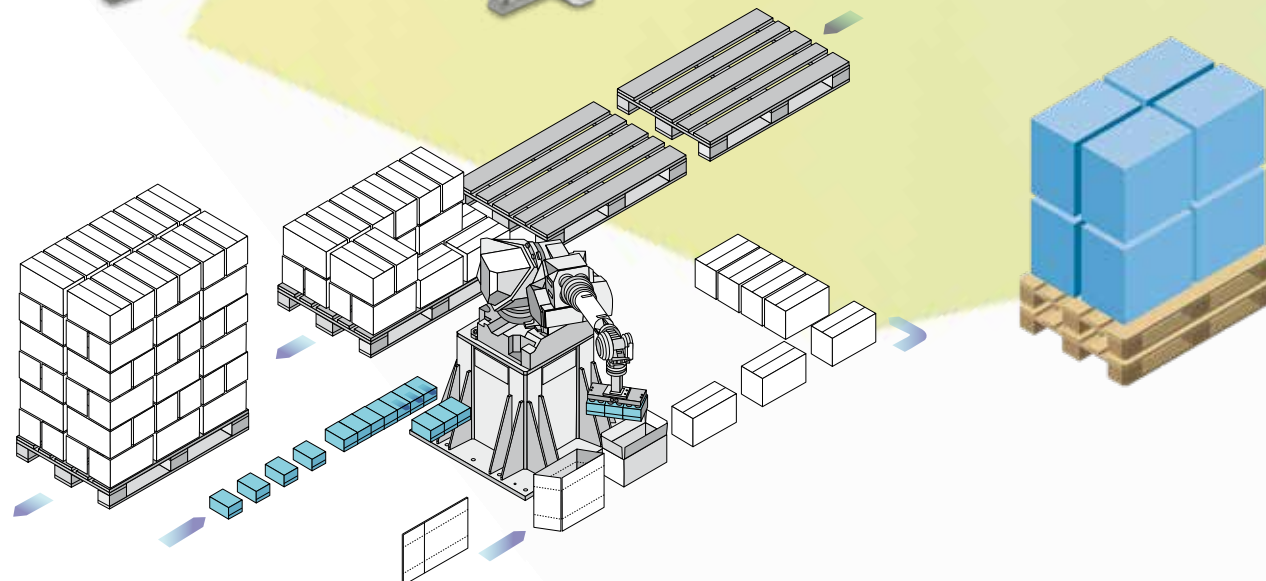

All these machines are available with



PAL

Palletiser

Full pallet dimensions

min. 800 x 1000 x 400 H mm.
max 1100 x 1280 x 2000 H mm.

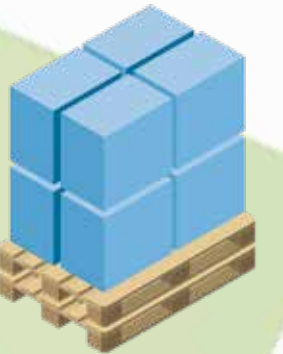
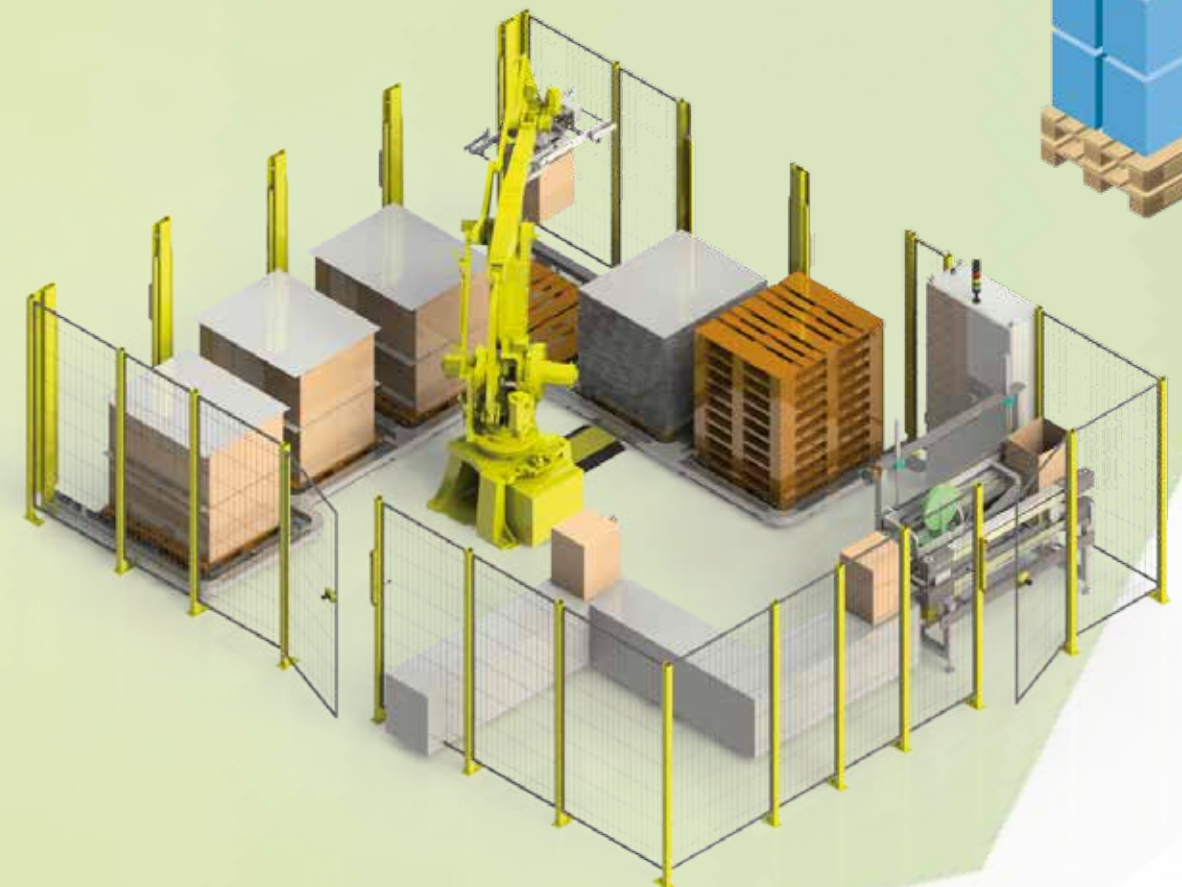

Features:

Anthropomorphic or Cartesian robot technology, according to performance requirements

Highly customisable layout

Possibility of integration with pallet and interlayer sheet magazines

Delicate handling of products to guarantee total integrity

DE-PAL version with recovery of packaging materials for packaging sustainability

Management of packaging materials to be recovered for packaging sustainability

Innovative user-friendly HMI interface

Senzani After Sales

A Universe of Services

To ensure excellent performance and maximum machine life, as well as the total efficiency and productivity of the plants in which the machines operate, Senzani supports the Customer in every phase of the project: research, development and technical expertise are the key to facing future challenges and meeting every Customer's exclusive need.

Machine users' satisfaction is our top priority: that is why we provide worldwide after-sale service and support, devoting our time, professionalism and know-how to improve our Customers' productivity.



24h Assistance and remote assistance

Specialised technicians are available 24/7 to provide Customers with a continuous and high-quality support service, minimising downtime. Senzani technicians are available through a remote assistance service and are able to reach the Customers wherever they are.

Programmed preventive maintenance

In order to ensure high performances and long-term machine efficiency, we offer scheduled preventive maintenance and servicing. We arrange customised interventions to constantly monitor the machines performances.



Original spare parts

Senzani guarantees the availability of spare parts without time restrictions, both for the new solutions, and for the more outdated models. Original spare parts are manufactured according to rigorous quality standards ensuring optimal performance and reliability over time.

Training

Senzani provides production assistance services and offers specific operator training on the correct use and handling of the purchased machines. A comprehensive staff training and ongoing education are crucial to provide the personnel with the suitable technical skills to ensure the high productivity of the machines.



Upgrade and Revamping

Thanks to their high degree of flexibility and compatibility, Senzani's solutions can be modified over time to meet the Customer's specific needs and accommodate any market evolution. New functions and technology implementation, components replacement and upgrades allows the machines to be adjusted according to new formats and demands.

Relocation

Senzani offers on-site machine modifications and overhauling services. Specialised staff members, specifically trained for machinery disassembling and re-assembling, are available to fulfil every request, including the relocation of machinery to sites other than the one they were first installed.

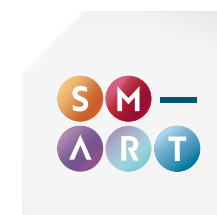

Smart

Senzani is at your side with SMART (Senzani Machine Analysis Remote Technology), the new platform that allows you to easily monitor the performance and productivity of Senzani machines directly from your PC, tablet or smart-phone – wherever you are and at any time. Moreover, you can share data with Senzani technicians for ongoing remote support.



Senzani Brevetti SpA
Viale Risorgimento, 13/15 - 48018 Faenza RA
Tel. +39 0546.624011 - Fax +39 0546.621316
www.senzani.com - info@senzani.com

